

Ambient Temperature Limits: -40° F to 150° F (-40° C to 65° C)  
 Process Temperature Limits: -40° F to 150° F (-40° C to 65° C)  
 Case Material: Steel, painted black  
 Lens Material: Polycarbonate  
 Dial: Aluminum  
 Tube: Ph Bz  
 Movement: Flutterless, brass  
 Socket: Brass  
 Welding: Silver Alloy  
 Accuracy:  $\pm 2-1-2\%$   
 Enclosure Rating: IP52

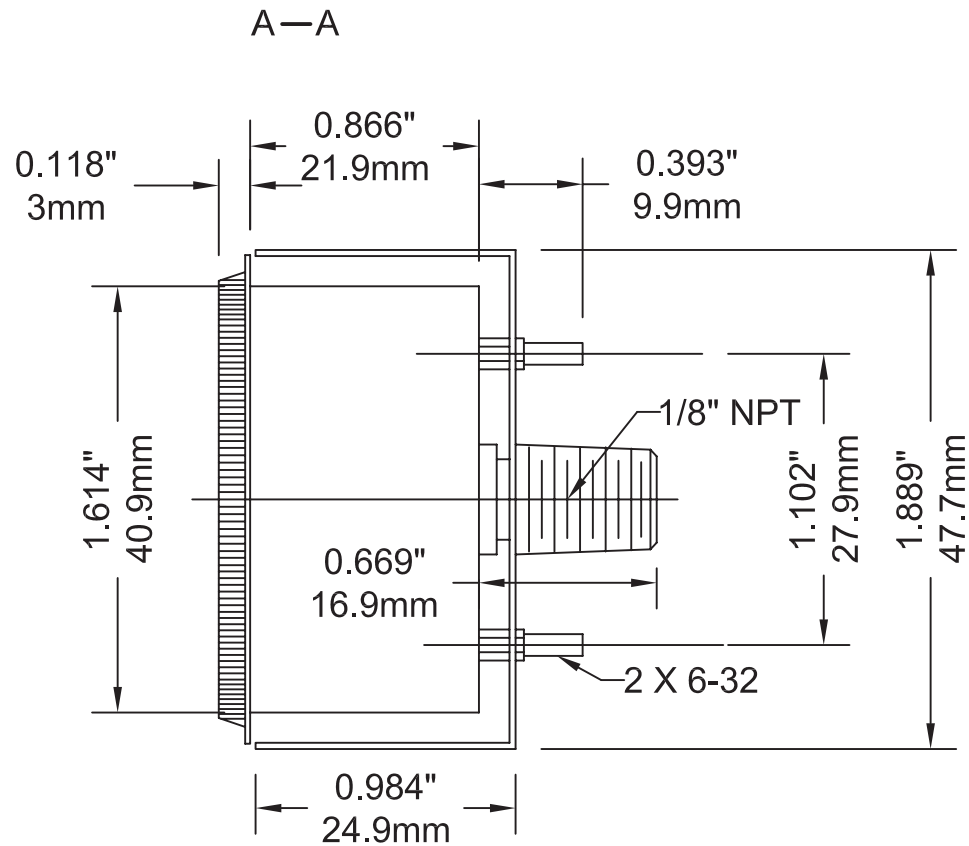
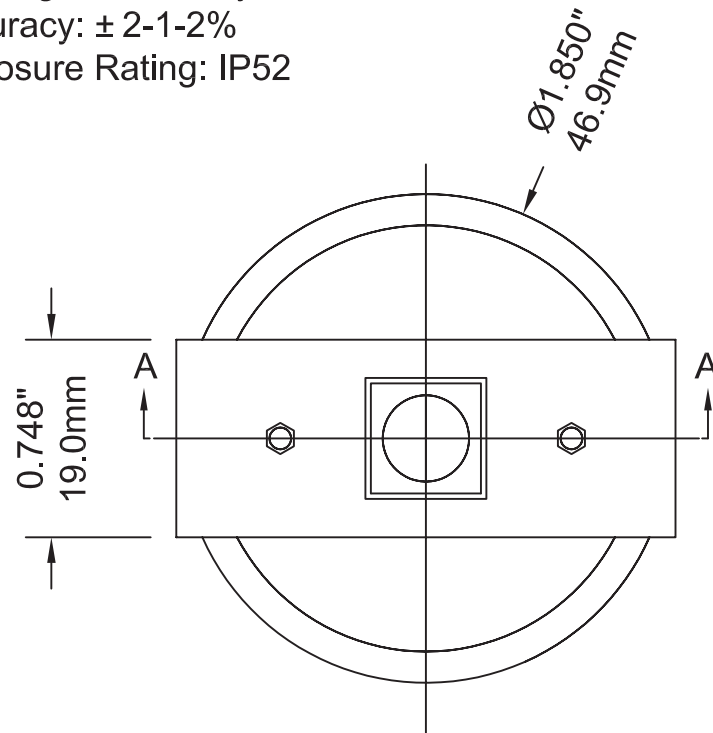

DRAWN BY: PHOEBE MA

ENG. APPROVAL:

ALL DIMENSIONS IN INCHES/MM

TOLERANCES  
(unless otherwise stated)

|             |                        |
|-------------|------------------------|
| Fractional: | $\frac{1}{64}$ " 0.4mm |
| Decimal:    | 0.06" 1.5mm            |

REVISION No. & DATE: Jan. 08, 2009

TITLE:

1.5" 90 SERIES QUALITY GAUGE, BACK  
CONNECTION WITH "U" CLAMP

DRAWING NO: P9U-15-Y-B-W